

Metric 90 Elbows 1.5D - OSTP Tru-Bore®

Type 316L and Type 304L

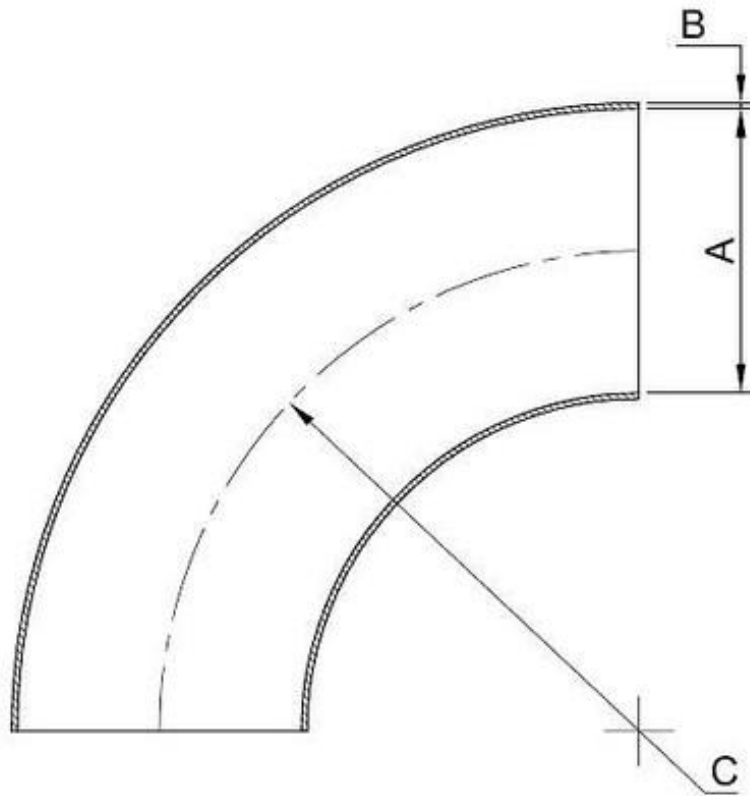

Metric 90 Elbows 1.5D - OSTP Tru-Bore®

Type 316L and Type 304L



Inside	Wall	Centre line	Weight	Product	Product
Diameter	Thickness	Radius	Per Piece	Code	Code
'A' mm	'B' mm	'C' mm	Kilos	316L	304L
15	1.5	22.5	0.03	102A015150	102B015150
20	1.5	25	0.04	102A020150	102B020150
25	1.5	32.5	0.05	102A025150	102B025150
32	1.5	45	0.08	102A032150	102B032150
40	2	60	0.16	102A040200	102B040200
50	2	73	0.28	102A050200	102B050200
65	2	95	0.47	102A065200	102B065200
80	2	123	0.9	102A080200	102B080200
100	2	150	1.2	102A100200	102B100200
100	3	150	1.8	102A100300	102B100300
125	2	188	2	102A125200	102B125200
150	2	225	2.6	102A150200	102B150200
150	3	225	3.9	102A150300	102B150300