

Metric 90 Bends Type D+100 - OSTP Tru-Bore®

Type 316L and Type 304L

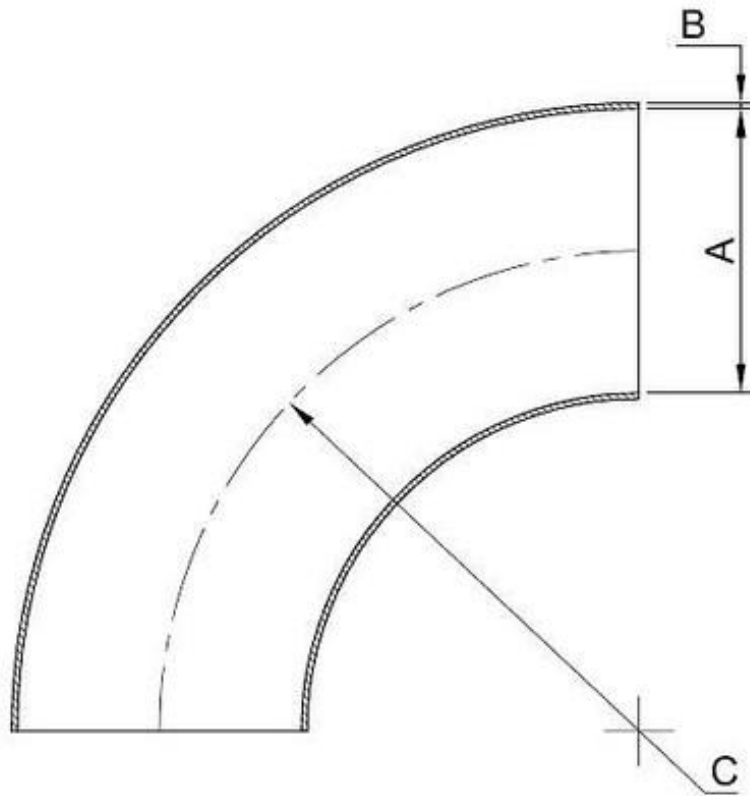

Metric 90 Bends Type D+100 - OSTP Tru-Bore®

Type 316L and Type 304L



Inside	Wall	Centre line	Weight	Product	Product
Diameter	Thickness	Radius	Per Piece	Code	Code
'A' mm	'B' mm	'C' mm	Kilos	316L	304L
50	2	150	0.61	101A050200	101B050200
80	2	180	1.16	101A080200	101B080200
100	2	200	1.61	101A100200	101B100200
100	3	200	2.43	101A100300	101B100300
125	2	225	2.25	101A125200	101B125200
150	2	250	2.99	101A150200	101B150200
150	3	250	4.51	101A150300	101B150300
200	2	300	4.77	101A200200	101B200200
200	3	300	7.19	101A200300	101B200300
250	2	350	6.94	101A250200	101B250200
250	3	350	10.45	101A250300	101B250300
300	2	400	9.52	101A300200	101B300200
300	3	400	14.3	101A300300	101B300300
350	3	450	18.74	101A350300	101B350300
400	3	500	23.78	101A400300	101B400300
450	3	550	29.4	101A450300	101B450300
500	3	600	35.61	101A500300	101B500300
600	3	700	49.9	101A600300	101B600300
700	4	800	88.6	101A700400	101B700400
800	4	900	113.84	101A800400	101B800400
900	4	1000	142.22	101A900400	101B90040
1000	5	1100	217	101AA100500	101BB100500
1200	5	1800	438	102AA120500	102BB120500