

SMS-416 - ISO Eccentric Reducers

Type 316L and Type 304L

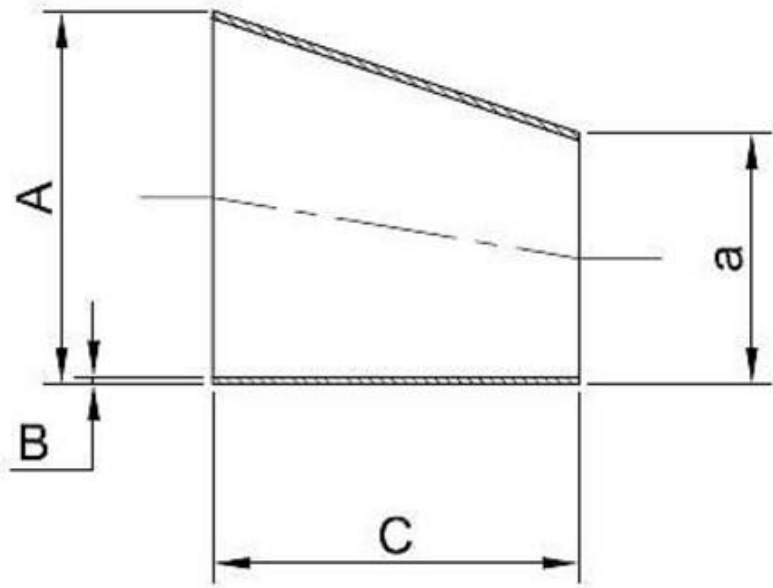

SMS-416 - ISO Eccentric Reducers

Type 316L and Type 304L



Outside Diameter	Outside Diameter	Wall Thickness	Overall Length	Weight Per Piece	Product Code	Product Code
A' mm	a' mm	B' mm	C' mm	Kilos	316L	340L
26.90	21.3	2.00	17	0.02	416A269213	416B269213
33.70	21.3	2.00	37	0.05	416A337213	416B337213
33.70	26.9	2.00	20	0.03	416A337269	416B337269
42.40	21.3	2.00	63	0.1	416A424213	416B424213
42.40	26.9	2.00	46	0.08	416A424269	416B424269
42.40	33.7	2.00	26	0.05	416A424337	416B424337
48.30	21.3	2.00	81	0.14	416A483213	416B483213
48.30	26.9	2.00	64	0.12	416A483269	416B483269
48.30	33.7	2.00	44	0.09	416A483337	416B483337
48.30	42.4	2.00	18	0.04	416A483424	416B483424
60.30	21.3	2.00	117	0.24	416A603213	416B603213
60.30	26.9	2.00	100	0.22	416A603269	416B603269
60.3	33.7	2.00	80	0.19	416A603337	416B603337
60.3	42.4	2.00	54	0.14	416A603424	416B603424
60.3	48.30	2.00	36	0.10	416A603483	416B603483
76.10	26.90	2.00	148	0.38	416A761269	416B761269
76.10	33.70	2.00	127	0.35	416A761337	416B761337
76.10	42.40	2.00	101	0.30	416A761424	416B761424
76.10	48.30	2.00	83	0.26	416A761483	416B761483
76.10	60.30	2.00	47	0.16	416A761603	416B761603
88.90	33.70	2.00	166	0.51	416A889337	416B889337
88.90	42.40	2.00	139	0.46	416A889424	416B889424
88.90	48.30	2.00	122	0.43	416A889483	416B889483
88.90	60.30	2.00	86	0.32	416A889603	416B889603
88.90	76.10	2.00	38	0.16	416A889761	416B889761
114.30	26.90	2.00	262	0.93	416A114269	416B114269
114.30	33.70	2.00	242	0.90	416A114337	416B114337
114.30	42.40	2.00	216	0.85	416A114424	416B114424
114.30	48.30	2.00	198	0.8	416A114483	416B114483
114.30	60.30	2.00	162	0.71	416A114603	416B114603
114.30	76.10	2.00	115	0.55	416A114761	416B114761

SMS-416 - ISO Eccentric Reducers

Type 316L and Type 304L



Outside	Outside	Wall	Overall	Weight	Product	Product
Diameter	Diameter	Thickness	Length	Per Piece	Code	Code
A' mm	a' mm	B' mm	C' mm	Kilos	316L	340L
114.30	88.90	2.00	76	0.39	416A114889	416B114889
139.7	60.30	2.00	238	1.20	416A139603	416B139603
139.70	76.10	2.00	191	1.04	416A139761	416B139761
139.70	88.90	2.00	152	0.88	416A139889	416B139889
139.70	114.30	2.00	76	0.49	416A139114	416B139114
168.30	60.30	2.00	324	1.87	416A168603	416B168603
168.30	76.10	2.00	277	1.71	416A168761	416B168761
168.30	88.90	2.00	238	1.55	416A168889	416B168889
168.30	114.30	2.00	162	1.16	416A168114	416B168114
168.30	139.70	2.00	86	0.67	416A168139	416B168139
219.10	88.90	2.00	391	3.05	416A219889	416B219889
219.10	114.30	2.00	314	2.66	416A219114	416B219114
219.10	139.70	2.00	238	2.16	416A219139	416B219139
219.10	168.30	2.00	152	1.50	416A219168	416B219168
273.00	114.30	2.00	476	4.67	416A273114	416B273114
273.00	139.70	2.00	400	4.18	416A273139	416B273139
273.00	168.30	2.00	314	3.51	416A273168	416B273168
273.00	219.10	2.00	162	2.02	416A273219	416B273219
323.90	114.30	2.00	629	6.90	416A323114	416B323114
323.90	139.70	2.00	553	6.49	416A323139	416B323139
323.90	168.70	2.00	467	5.82	416A323168	416B323168
323.90	219.10	2.00	314	4.32	416A323219	416B323219
323.90	273.00	2.00	153	2.31	416A323273	416B323273